

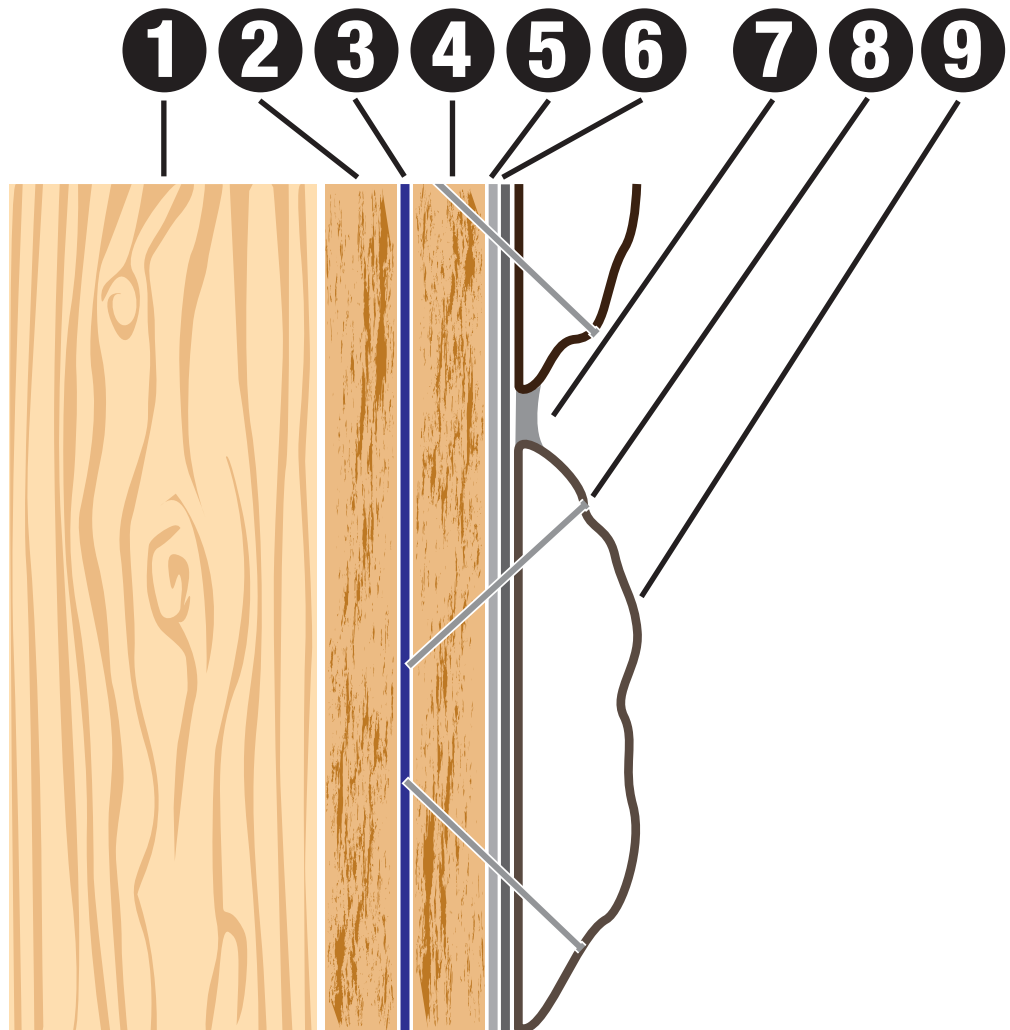

Typical Exterior Wall Plastirock™ Application Cross Section.



- 1.** Exterior wall stud.
- 2.** Exterior sheathing of structure.
- 3.** Weather resistant barrier (ex. Tyvek®).
- 4.** Exterior sheathing, recommended minimum 3/8" thick plywood, oriented strand board (OSB), or equivalent.
- 5.** Exterior primer.
- 6.** Exterior paint. If mortar repair or masonry repair will be used to fill gaps between rocks, it is recommended that the paint be color matched to the mortar repair or masonry repair color in the event of gaps in the application.
- 7.** Mortar repair or masonry repair.
- 8.** Two inch brad nails, installed at opposing 45 degree angles to wall surface for strongest bond.
- 9.** Plastirock™.

Installation of Plastirock must be in accordance with all Government regulation, including local building, environmental, fire and safety Codes to ensure compliance with margins of safety among other things. Manufacturer assumes no responsibility for any installation or application which does not comply with Government regulation.

Tyvek® is a registered trademark of E. I. du Pont de Nemours and Company or its affiliates.

Like all organic materials, plastic and wood are combustible and will burn. The flammability tests conducted on the polymer used to produce Plastirock™ were in accordance with the standard tests for flammability of plastic materials for parts and devices and appliances, UL 94 5th Edition. The material was rated "HB".

1-888-822-8846